

Issued 1987-04  
Reaffirmed 2002-12

Superseding J1354 SEP1995

## Nomenclature—Forwarder

1. **Scope**—This SAE Recommended Practice identifies major components and parts peculiar to forwarders. Illustrations used here are not intended to include all existing machines or to be exactly descriptive of any particular machine. They have been provided to illustrate the principles to be used in applying this document.

1.1 **Purpose**—The purpose of this document is to provide standardization of terms for major components of forwarders.

2. **References**

2.1 **Related Publication**—The following publication is provided for information purposes only and is not a required part of this document.

2.1.1 SAE PUBLICATION—Available from SAE, 400 Commonwealth Drive, Warrendale, PA 15096-0001.

SAE J1209—Identification Terminology of Mobile Forestry Machines

3. **Definitions**

3.1 **Forwarder**—A self-propelled machine, usually self-loading, designed to transport trees or parts of trees by carrying them completely off the ground.

Two particular types of forwarders have been identified:

3.1.1 **SHORTWOOD (FIGURE 1)**—This machine usually employs a fixed bunk designed to carry parts of trees, shortwood, or log lengths.

3.1.2 **WHOLE TREE/TOTAL TREE/TREE LENGTH (FIGURE 2)**—This machine usually employs a pivoting bunk designed to handle whole tree, total tree, or tree lengths such that the whole load can be dumped at one time.

SAE Technical Standards Board Rules provide that: "This report is published by SAE to advance the state of technical and engineering sciences. The use of this report is entirely voluntary, and its applicability and suitability for any particular use, including any patent infringement arising therefrom, is the sole responsibility of the user."

SAE reviews each technical report at least every five years at which time it may be reaffirmed, revised, or cancelled. SAE invites your written comments and suggestions.

Copyright ©2002 Society of Automotive Engineers, Inc.

All rights reserved. No part of this publication may be reproduced, stored in a retrieval system or transmitted, in any form or by any means, electronic, mechanical, photocopying, recording, or otherwise, without the prior written permission of SAE.

TO PLACE A DOCUMENT ORDER:

Tel: 877-606-7323 (inside USA and Canada)  
Tel: 724-776-4970 (outside USA)  
Fax: 724-776-0790  
Email: [custsvc@sae.org](mailto:custsvc@sae.org)  
<http://www.sae.org>

SAE WEB ADDRESS:

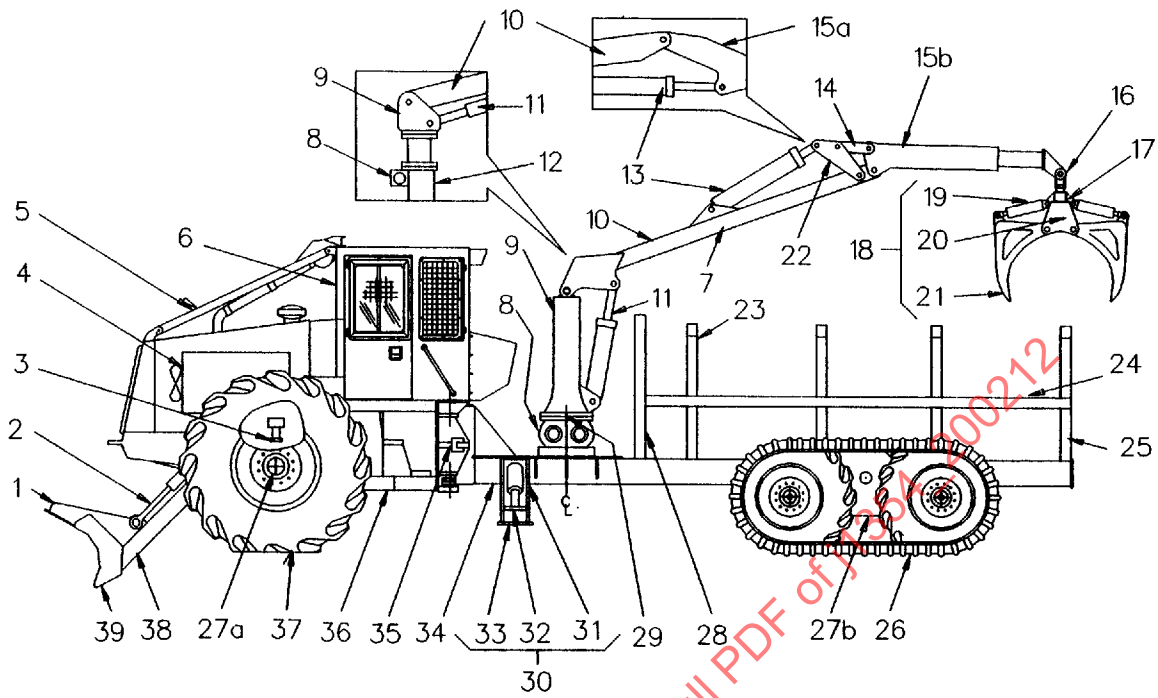

FIGURE 1—SHORTWOOD

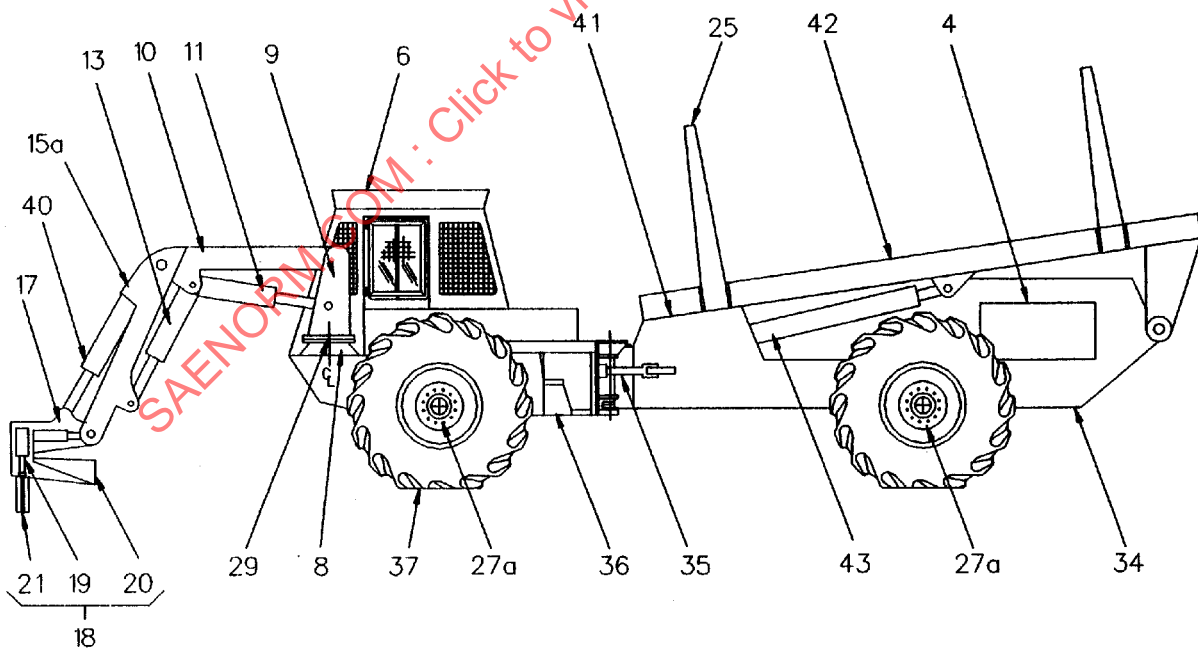

FIGURE 2—WHOLE TREE/TOTAL TREE/TREE LENGTH

#### 4. **Nomenclature**

1. Decking Lug
2. Blade Cylinder
3. Oscillation Lock (Axle or Frame Oscillation)
4. Engine
5. Sweep
6. Operator Enclosure
7. Loader Mechanism composed of items 8 through 22
8. Swing Assembly
9. Head
10. Main Boom
11. Main Boom Cylinder
12. Mast
13. Stick (Secondary) Boom Cylinder
14. Link
15. Stick (Secondary) Boom
  - a. Fixed
  - b. Telescopic
16. Grapple Yoke
17. Grapple Rotator Assembly
18. Grapple
19. Grapple Arm Cylinder
20. Grapple Head
21. Grapple Arm
22. Lever
23. Stake Extension
24. Tie Bars
25. Stake
26. Bogie Track
27. Axle
  - a. Single
  - b. Bogie
28. Headboard
29. Axis of Rotation
30. Stabilizer
31. Stabilizer Arm
32. Stabilizer Cylinder
33. Stabilizer Pad
34. Rear Frame
35. Steering Cylinder
36. Front Frame
37. Tire
38. Blade Arm
39. Blade
40. Tilt Cylinder
41. Bunk Support
42. Bunk
43. Dump Cylinder

PREPARED BY THE SAE MACHINE TECHNICAL COMMITTEE SC4—  
FORESTRY AND LOGGING EQUIPMENT