

SAE-AS9375

ADOPTION NOTICE

SAE-AS9375, "GASKET - METAL O-RING, .094 TUBE X .010 WALL, SILVER PLATED ", was adopted on 29 DECEMBER 1999 for use by the Department of Defense ( DoD). Proposed changes by DoD Activities must be submitted to the DoD Adopting Activity: Defense Supply Center Philadelphia, ATTN: DSCP-ILEA, 700 Robbins Avenue, Philadelphia, PA 19111-5096. DoD Activities may obtain copies of this standard from the Standardization Document Order Desk, 700 Robbins Avenue, Building 4D, Philadelphia, PA 19111-5094. The private sector and other Government agencies may purchase copies from the SOCIETY OF AUTOMOTIVE ENGINEERS, INC., 400 COMMONWEALTH DRIVE, WARRENDALE, PA 15096-0001 .

Custodians:

Navy - AS  
Air Force - 11  
DLA-IS

Adopting activity:

DLA-IS

(Project 5330-1178-007)

AMSC N/A

FSC 5330

DISTRIBUTION STATEMENT A . Approved for public release; distribution is unlimited.

FEDERAL SUPPLY CLASS  
5330

AS9375

## NOTICE

THIS DOCUMENT HAS BEEN TAKEN DIRECTLY FROM U.S. MILITARY SPECIFICATION MS9375A, AMENDMENT 1 AND CONTAINS ONLY MINOR EDITORIAL AND FORMAT CHANGES REQUIRED TO BRING IT INTO CONFORMANCE WITH THE PUBLISHING REQUIREMENTS OF SAE TECHNICAL STANDARDS. THE INITIAL RELEASE OF THIS DOCUMENT IS INTENDED TO REPLACE MS9375A, AMENDMENT 1. ANY PART NUMBERS ESTABLISHED BY THE ORIGINAL SPECIFICATION REMAIN UNCHANGED.

THE ORIGINAL MILITARY SPECIFICATION WAS ADOPTED AS AN SAE STANDARD UNDER THE PROVISIONS OF THE SAE TECHNICAL STANDARDS BOARD (TSB) RULES AND REGULATIONS (TSB 001) PERTAINING TO ACCELERATED ADOPTION OF GOVERNMENT SPECIFICATIONS AND STANDARDS. TSB RULES PROVIDE FOR (A) THE PUBLICATION OF PORTIONS OF UNREVISED GOVERNMENT SPECIFICATIONS AND STANDARDS WITHOUT CONSENSUS VOTING AT THE SAE COMMITTEE LEVEL, AND (B) THE USE OF THE EXISTING GOVERNMENT SPECIFICATION OR STANDARD FORMAT.

UNDER DEPARTMENT OF DEFENSE POLICIES AND PROCEDURES, ANY QUALIFICATION REQUIREMENTS AND ASSOCIATED QUALIFIED PRODUCTS LISTS ARE MANDATORY FOR DOD CONTRACTS. ANY REQUIREMENT RELATING TO QUALIFIED PRODUCTS LISTS (QPL'S) HAS NOT BEEN ADOPTED BY SAE AND IS NOT PART OF THIS SAE TECHNICAL DOCUMENT.

THIRD ANGLE PROJECTION

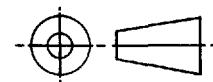

PREPARED BY SAE COMMITTEE E-25

PROCUREMENT SPECIFICATION: AS7325

**SAE** The Engineering Society  
For Advancing Mobility  
Land Sea Air and Space  
**INTERNATIONAL**  
400 Commonwealth Drive, Warrendale, PA 15096-0001

**AEROSPACE STANDARD**

GASKET-METAL O-RING, .094 TUBE X .010 WALL,  
SILVER PLATED

**AS9375**  
SHEET 1 OF 3

ISSUED 1999-12

SAE Technical Standards Board Rules provide that: "This report is published by SAE to advance the state of technical and engineering sciences. The use of this report is entirely voluntary, and its applicability and suitability for any particular use, including any patent infringement arising therefrom, is the sole responsibility of the user." SAE reviews each technical report at least every five years at which time it may be reaffirmed, revised, or cancelled. SAE invites your written comments and suggestions.

Copyright 1999 Society of Automotive Engineers, Inc.  
All rights reserved.

QUESTIONS REGARDING THIS DOCUMENT: (724) 772-8510  
TO PLACE A DOCUMENT ORDER: (724) 776-4970

FAX: (Distributed under license from the IHS Archive) PRESS:  
FAX: (24) 776-0790

<http://www.sae.org>

Printed in the U.S.A.

AS9375

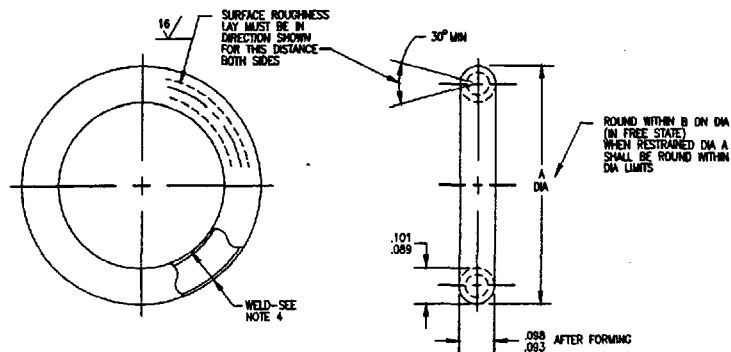

FIGURE 1

TABLE I

PART NO.	A +.005 -.000	B	APPROX WEIGHT LB/100	PART NO.	A +.005 -.000	B	APPROX WEIGHT LB/100	PART NO.	A +.005 -.000	B	APPROX WEIGHT LB/100
*MS9375-010	1.000	.030	.336	*MS9375-047	2.750	.060	.924	MS9375-107	6.500	.090	2.182
MS9375-012	1.031	.030	.346	MS9375-048	2.812	.060	.945	MS9375-111	6.750	.090	2.265
MS9375-013	1.062	.030	.356	MS9375-049	2.875	.060	.965	*MS9375-115	7.000	.090	2.350
MS9375-014	1.094	.030	.368	MS9375-050	2.938	.060	.987	MS9375-119	7.250	.090	2.432
*MS9375-015	1.125	.030	.378	*MS9375-051	3.000	.060	1.008	MS9375-123	7.500	.090	2.520
MS9375-016	1.156	.030	.388	MS9375-052	3.062	.060	1.028	MS9375-127	7.750	.090	2.600
MS9375-017	1.188	.030	.399	MS9375-053	3.125	.060	1.049	*MS9375-131	8.000	.090	2.690
MS9375-018	1.219	.030	.409	MS9375-054	3.188	.060	1.070	MS9375-135	8.250	.090	2.770
*MS9375-019	1.250	.030	.419	MS9375-055	3.250	.060	1.090	MS9375-139	8.500	.090	2.860
MS9375-020	1.281	.030	.431	MS9375-056	3.312	.060	1.112	MS9375-143	8.750	.090	2.940
MS9375-021	1.312	.030	.441	MS9375-057	3.375	.060	1.132	*MS9375-147	9.000	.090	3.020
MS9375-022	1.344	.030	.451	MS9375-058	3.438	.060	1.155	MS9375-151	9.250	.090	3.105
*MS9375-023	1.375	.030	.462	*MS9375-059	3.500	.060	1.175	MS9375-155	9.500	.090	3.200
MS9375-024	1.406	.030	.472	MS9375-060	3.562	.060	1.195	MS9375-159	9.750	.090	3.280
MS9375-025	1.438	.030	.484	MS9375-061	3.625	.060	1.218	*MS9375-163	10.000	.090	3.360
MS9375-026	1.469	.030	.494	MS9375-062	3.688	.060	1.238	MS9375-167	10.250	.125	3.440
*MS9375-027	1.500	.030	.504	MS9375-063	3.750	.060	1.260	MS9375-171	10.500	.125	3.520
MS9375-028	1.562	.030	.524	MS9375-064	3.812	.060	1.280	MS9375-175	10.750	.125	3.610
MS9375-029	1.625	.030	.546	MS9375-065	3.875	.060	1.300	*MS9375-179	11.000	.125	3.700
MS9375-030	1.688	.030	.567	MS9375-066	3.938	.060	1.322	MS9375-183	11.250	.125	3.780
*MS9375-031	1.750	.030	.587	*MS9375-067	4.000	.060	1.342	MS9375-187	11.500	.125	3.860
MS9375-032	1.812	.030	.610	MS9375-069	4.125	.060	1.385	MS9375-191	11.750	.125	3.950
MS9375-033	1.875	.030	.630	MS9375-071	4.250	.060	1.428	*MS9375-195	12.000	.125	4.040
MS9375-034	1.938	.030	.651	MS9375-073	4.375	.060	1.470				
*MS9375-035	2.000	.030	.671	*MS9375-075	4.500	.060	1.510				
MS9375-036	2.062	.030	.691	MS9375-077	4.625	.060	1.555				
MS9375-037	2.125	.030	.714	MS9375-079	4.750	.060	1.600				
MS9375-038	2.188	.030	.735	MS9375-081	4.875	.060	1.640				
*MS9375-039	2.250	.030	.755	*MS9375-083	5.000	.060	1.680				
MS9375-040	2.312	.030	.776	MS9375-085	5.125	.090	1.720				
MS9375-041	2.375	.030	.797	MS9375-087	5.250	.090	1.760				
MS9375-042	2.438	.030	.820	MS9375-089	5.375	.090	1.805				
*MS9375-043	2.500	.030	.840	*MS9375-091	5.500	.090	1.850				
MS9375-044	2.562	.060	.860	MS9375-095	5.750	.090	1.933				
MS9375-045	2.625	.060	.881	*MS9375-099	6.000	.090	2.018				
MS9375-046	2.688	.060	.903	MS9375-103	6.250	.090	2.098				